



DANGER: LIVE PARTS ENCLOSED. Ensure the unit is installed by a qualified competent person in accordance with all relevant legislation and regulations including building regulations and wiring regulations BS 7671. If in doubt, contact a qualified competent person.



IMPORTANT INFORMATION

Follow the instructions below before working on or inside the equipment.



- Turn off all power supplies
- Always use a calibrated volt-sensing device to confirm the power is off.
- Replace all devices, doors and covers before turning on the power to this equipment.
- To avoid ingress of swarf and similar material, always remove gland plates to allow cutting/slotting for cable entries.
- Do not use power screwdrivers on electrical connections.



Failure to follow these instructions could result in serious injury or death.

DO NOT USE POWER TOOL SCREWDRIVERS ON ELECTRICAL CONNECTIONS

Fitting Instruction

Remove the door and front plate from the main panel board.

The mounting bracket and copper links come pre-assembled, mount the assembly to the incomer mounting plate using the No. 10 x 6 mm pozi screws provided. Refer to Fig. 1 for details.

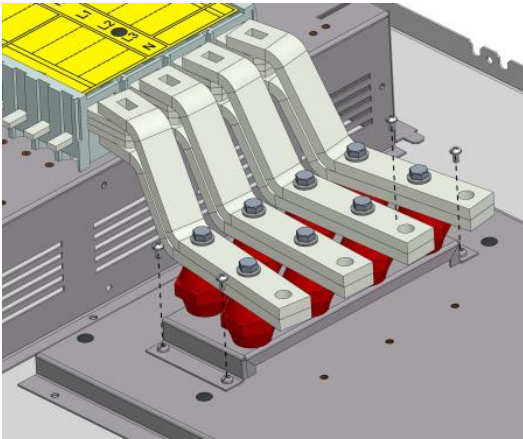

Fig. 1

Once the kit has been attached to the mounting plate start to secure the coppers by using the fasteners specified in Fig. 2. Loosen the M8 Hex Bolts (Item No. 2 in the table below) for the easier fitment.

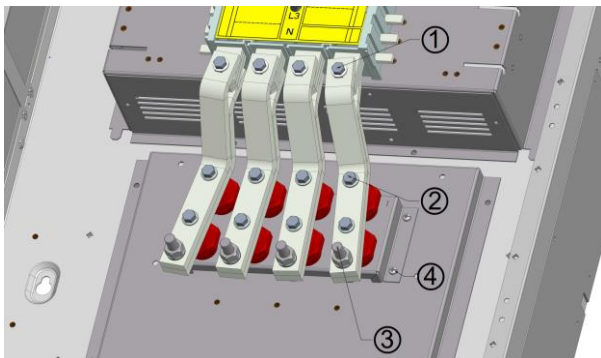

Fig. 2

No.	Description	Torque Setting
1	M8 x 50 mm Hex Bolt, Washer	25 Nm
2	M8 x 30 mm Hex Bolt, Washer	10 Nm
3	M12 x 50 mm Hex Bolt, Washer and Nut	40 Nm
4	No. 10 x 6 mm Pozi Screw	N/A

Assemble the shroud and interphase barrier by using the snap-fit rivets provided. Remove any protective film the polycarbonate shroud and barrier parts before assembling. Once assembled attach to the incoming mounting plate. Refer to Fig. 3 for details.

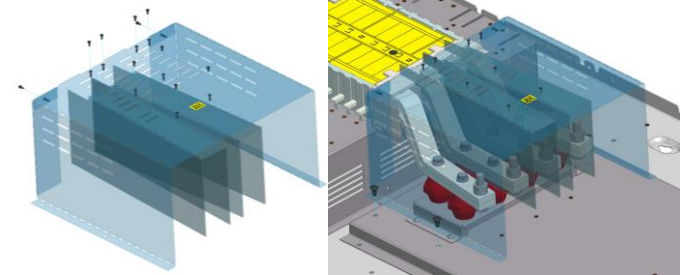

Fig. 3

Re-fitting Instruction

Re-fit the front shields to the panel board and assemble the blanking kit. Use the No. 10 x 9.5 mm pozi screws provided Refer to Fig. 4 for details.

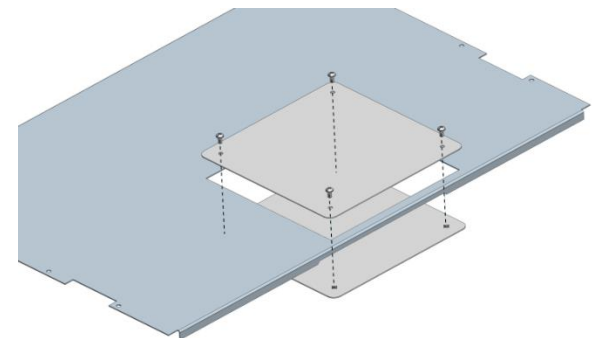

Fig. 4

Before fitting the door to the main panel board, check the tightness of **all** connections, including factory made connections.