



IMPORTANT INFORMATION

This unit should be installed by a qualified competent person in accordance with all relevant legislation and regulations including building regulations and wiring regulations BS 7671. If in doubt contact a qualified competent person.

- Turn off all power supplying this equipment before working on or inside the equipment.
- Always use a properly rated volt-sensing device to confirm the power is off.
- Replace all devices, doors and covers before turning on the power to this equipment.

Failure to follow these instructions could result in serious injury or death.

1. Technical Information

| | |
|---|--------------|
| BSI Standard | BSEN61643-11 |
| Type Test Class | Type 2 |
| Uc – Max. continuous operating voltage | 275 VAC |
| Up – Voltage protection level (L-N), (N-PE) | 1.3 kV |
| In – Nominal discharge current for class II | 20 kA |
| Imax – Maximum discharge current | 40 kA |
| Iscrc – Short circuit current rating | 25 kA |
| Degree of protection | IP20 |

2. Cartridge Indication

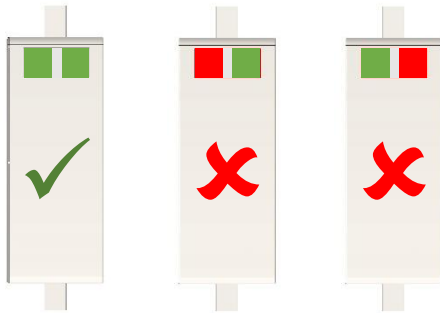

A full green window indicates a cartridge in good working order. Any red indication in the window means the cartridge is no longer working and must be replaced at the earliest opportunity.

3. Replacement Cartridge

The cartridge is fitted with internal overload protection and can take numerous surges before it will need to be replaced. For replacements contact your local wholesaler quoting the part number CRT2SPD/P

4. Cartridge Removal and Re-fitting

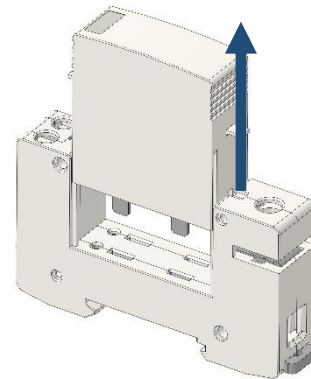

Remove the enclosure or consumer unit lid, slide the cartridge upwards from the base. Discard used cartridge in accordance with WEEE regulations.

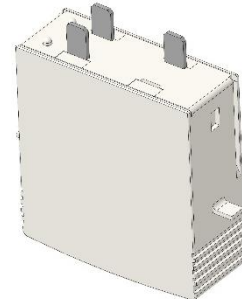

When fitting a new Cartridge care should be taken to align the two pips with the indents in the base module. The cartridge will only fit one way and should not be forced incorrectly. Ensure cartridge is inserted with no gaps to the base of the SPD.

5. Insulation resistance measurement

Unplug the cartridge before performing an insulation resistance measurement in the system, otherwise inaccurate measurements are possible. Re-fit cartridge as 4 above after the insulation resistance measurement.

